

New Features in Communicate: In Print Version 2.8

1. Free Updates for Symbols

One of the new features of In Print Version 2.8 is that it will allow you to get FREE updates to add to the Widgit Symbol sets. It is planned that from the end of the first quarter 2009 these will be issued quarterly. To enable this the graphic file structure has been re-organised in a new format. In Print V2.8 works happily with both formats.

Get the new symbol updates from www.widgit.com/symbolupdates

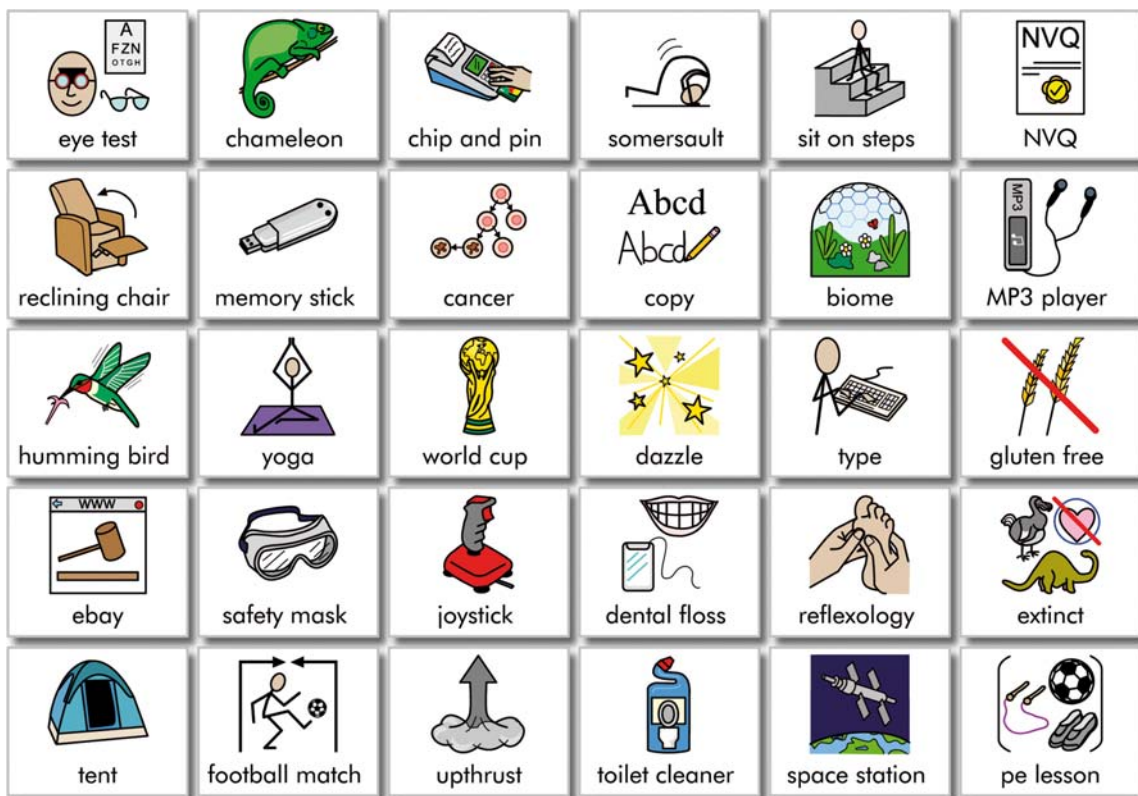

To edit and create wordlists with the new format images you need to use the new **Wordlist Manager**. This can be downloaded from www.widgit.com/support



2. New Grid Processing Features

It is now possible to specify the precise size of a grid, either when it is created or afterwards. Rows and columns can be inserted or deleted, and cell can be merged or unmerged.

All these features are available from the **Frames and Pictures** menu.

2-1. Making a Fixed Size Table

You can now make a table of a defined size. To do this, make a writing frame with the style you want for each cell of the table. Leave the frame with the cursor inside it and from the **Frames and Pictures** menu select **Make a table**.

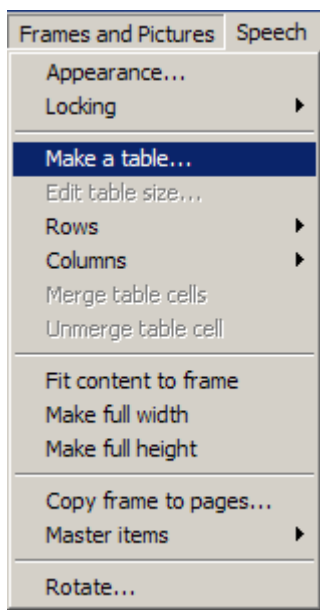

The following dialog will appear:

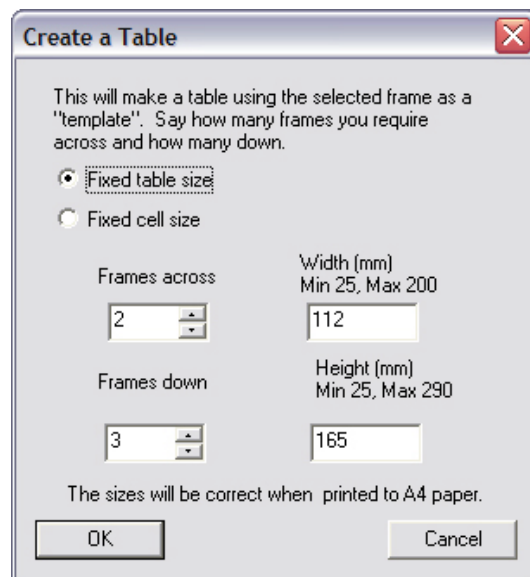

You can choose make a table of either:

- Fixed table size – This will use the values in mm to set the table size
- Fixed cell size – This will use the number of frames to set the table size

Select the radio button you require, then fill in the number of cells you wish to have. If you have chosen the first option, fill in the dimensions for the table. You can change the size of the table later, either by dragging, or setting the size in mm. See section 2.2.



2-2. Editing a Table Size

After you have made a table you can resize it, by dragging, to any size you like – see the main manual. However, if you want to make it an exact size when printed then proceed as follows. Select the table (right button click in **Create Mode**)

From the **Frames and Pictures** menu select **Edit table size**.

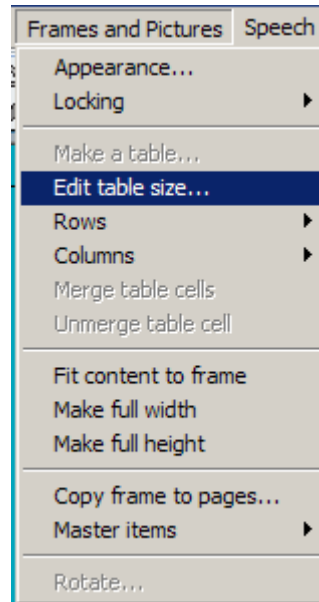

In the dialog box that appears enter the width and height you want for the table.

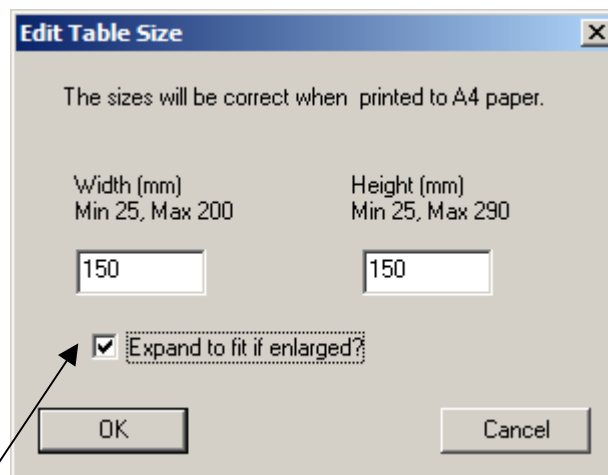

If you have made the table larger and want the contents of the cells to fill them, then check the **Expand to fit if enlarged** box. (Or you can use the **Expand** button - see main manual p10 - on individual cells after the dialog is closed). Click OK.



2-3. Rows and Columns

You can **insert** a row either above or below the row with the current cell (the one with the cursor in). From the **Frames and Pictures** menu select **Rows** or **Columns** to see the options.

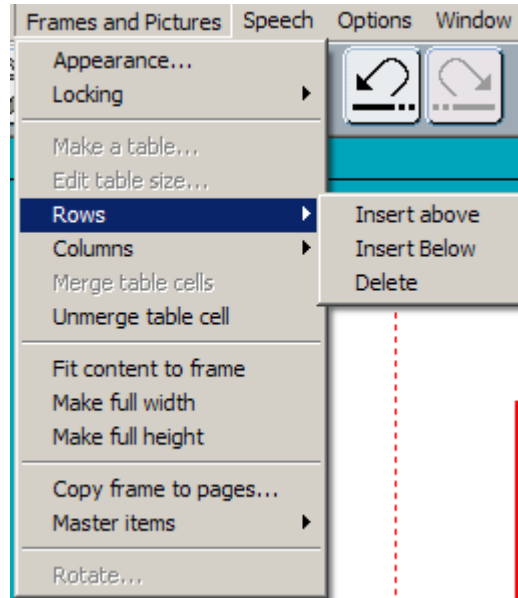

If there is no horizontal line above the row containing the selected cell, then **Insert above** will be greyed out. This will happen if you have merged cells and one of the merged cells “gets in the way” of the horizontal line.

Similarly for **Insert below** if there is no horizontal line below the selected cells.

Select which option you require and the row will be inserted.

To **delete** a row containing the cell with the cursor, simply select **Delete** in the above menu. If the cells in the row do not have a constant width (because of merging) then this option will be greyed out.

Exactly the same principles apply to inserting and deleting columns.

2-4. Merging Cells

Select the cells you want to merge. Use **CTRL +SHIFT + Left click** to multiply select items. The program will merge cells in a rectangle from the top-left cell to the bottom right of those selected. If you are in **Create** mode the selected cells will be marked by dotted lines around them. If you are in **Adjust** mode you will see the drag points.

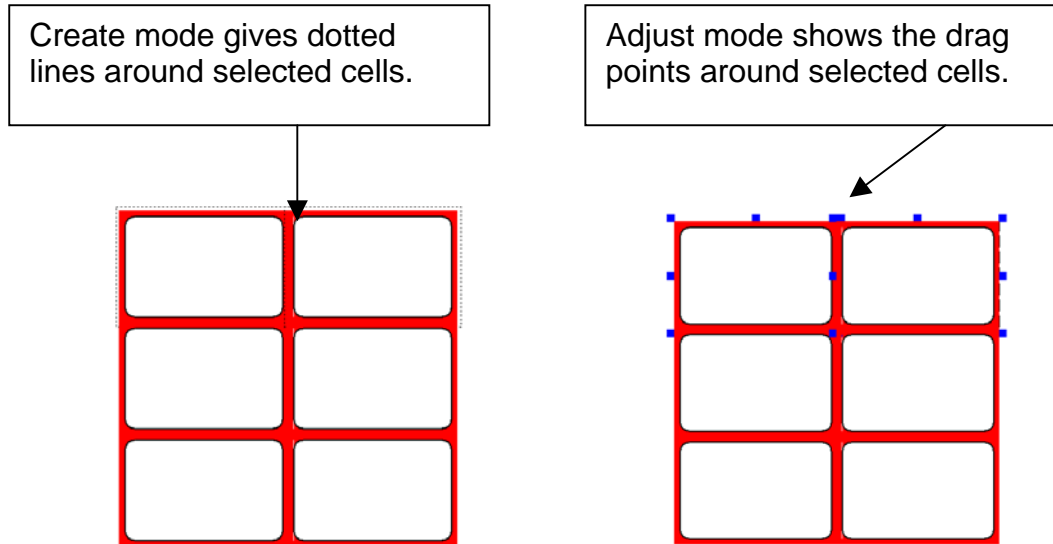

From the **Frames and Pictures** menu select **Merge table cells**.

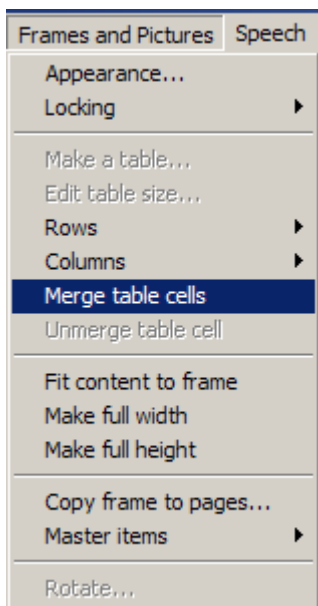

This will merge the cells as shown:

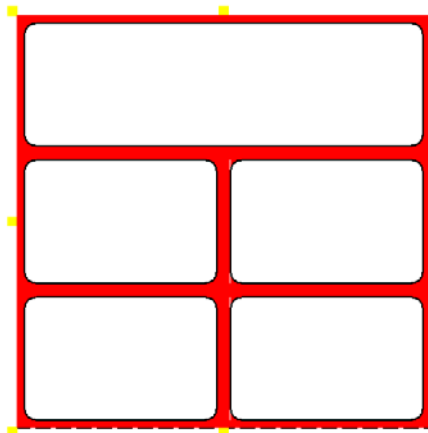

2-5. Unmerging Cells

Simply select the merged cell and from the **Frames and Pictures** menu select **Unmerge table cell**. The contents of the cell will be placed in the first of the unmerged cells.



2-6. Altering column widths and row heights

Go to **adjust mode** (second button on the left hand toolbar) and **right** button click a cell in the row or column you want to change.

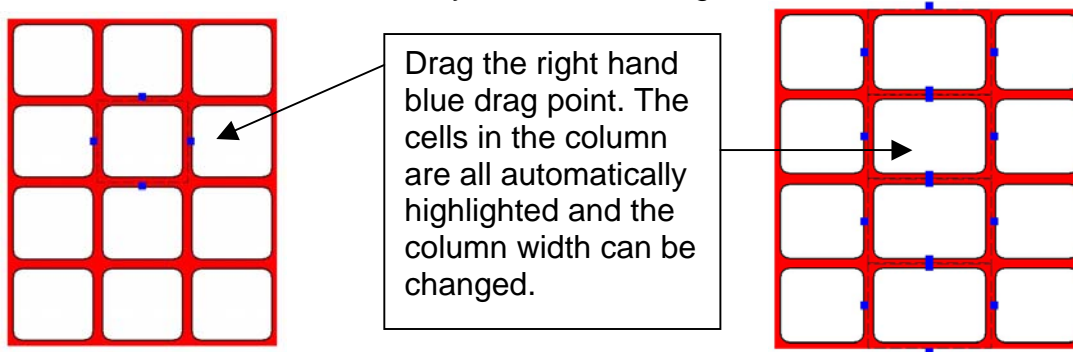

Click away when you have adjusted the column. Adjust the row height similarly.

3. Refresh Wordlist

If you have made changes to your wordlist in the Resource Manager or Wordlists Manager while you have In Print open, you may wish to reload the wordlists without closing and re opening the program. You can achieve this by selecting **Refresh wordlist** from the **Wordlists** menu.

4. Hide Guides

It can be useful to use guides to help you line up objects. But the guides can be unsightly for students. You can now show and hide guides without having to manually remove the. To do this go to the **View** menu then toggle **Show Guides**.

5. Minor Bug Fixes

Communicate: In Print Version 2.8 contains a number of minor bug fixes these include.

- Warning you if your default paper size becomes an American paper shape. This can happen from the default settings in some printers, or if a printer is not set up correctly.
- Increased default size of constrained frame. It is now 2x from the previous size.

Communicate: In Print 2 © Widgit Software 2009

Widgit Software
26 Queen St
Cubbington
Leamington Spa
Warwickshire
CV32 7NA

Tel: 01926 333680
Fax: 01926 885293

For help or technical support visit www.widgit.com/support
Or contact our technical support team on 01926 333680 support@widgit.com